

# Mobile Sanitary Systems for Civil Protection

---



OFF-GRID.



HYGIENIC.



MISSION-READY.



---

Reliable toilet and shower trailers  
for demanding operations.

# MOBILE CLEANING ZONE

Dirty in – clean out!



Subject to technical changes.  
Images may show optional equipment.

  
**MADE IN  
DÖBELN  
GERMANY**



- 800 litre fresh water tank
- 1500 litre waste water tank
- Direct mains connection
- Wood-free construction
- High-quality and durable
- Non-slip floor surface
- Ceramic interior fittings
- Water-saving taps
- Easy to clean (pressure washer compatible)
- Safe driving behaviour even with a full waste water tank (GVW 3,500 kg)
- Can be equipped with battery pack for initial deployment (without hot water supply)

# LAYOUTS

**GL4200 TANK 1x MOBILE DECONTAMINATION UNIT, 2 SINGLE TOILET CABINS, STORAGE COMPARTMENT**

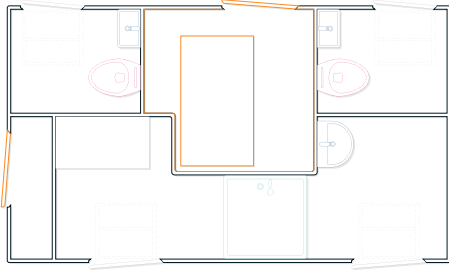

**GL4200 TANK 1x MOBILE DECONTAMINATION UNIT, SINGLE TOILET CABINS, URINAL COMPARTMENT**

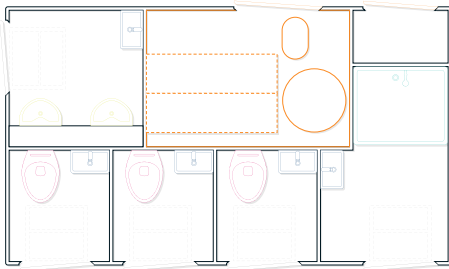

**GL4200 TANK 1x SHOWER, 3 SINGLE TOILET CABINS, 1 URINAL CABIN, STORAGE COMPARTMENT**

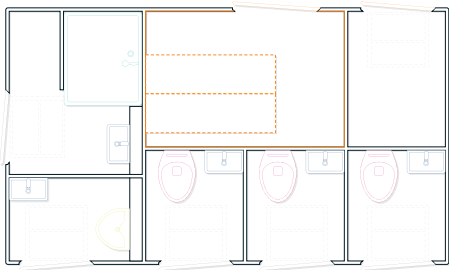

**GL4200 TANK 2x MOBILE DECONTAMINATION UNIT WITH TOILET**

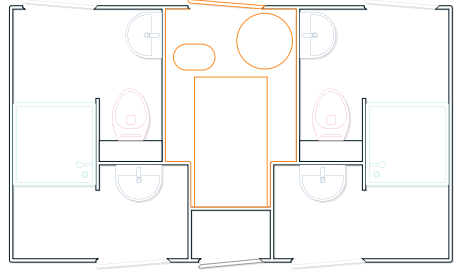

**GL4200 TANK 2x SHOWER, 3 SINGLE TOILET CABINS WITH URINAL**

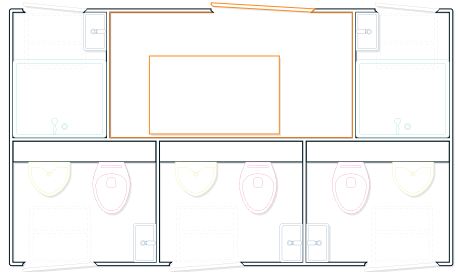

## SPECIFICATIONS

Number of axles	2
Interior height	2150 mm
Total height	2950 mm
Interior width	2400 mm
Exterior width	2470 mm
Total width (incl. mudguard)	2400 mm
Interior length	4200 mm
Total length (incl. drawbar)	5800 mm
Gross vehicle weight	3500 kg
Power connection	400 V, 16 A
Capacity fresh water	800 l
Capacity waste water	1500 l
Fresh water connection	3/4"
Waste water connection	DN110
Hot water supply with gas available on request	

# GL2800 TOILET AND SHOWER TRAILERS



Subject to technical changes.  
Images may show optional equipment.

- 400 litre fresh water tank
- 800 litre waste water tank
- Direct mains connection
- Wood-free construction
- High-quality and durable
- Non-slip floor surface
- Ceramic interior fittings
- Waste water tank in the vehicle chassis
- Optionally available with vacuum technology or solar package

  
**MADE IN  
DÖBELN  
GERMANY**

# LAYOUT

## GL2800

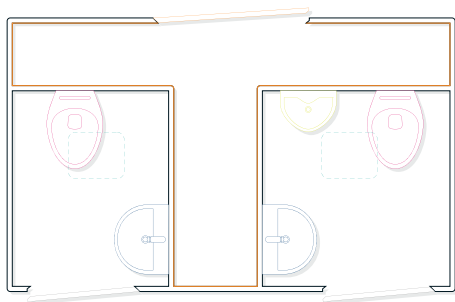

## SPECIFICATIONS

Number of axles	1
Interior height	2150 mm
Total height	2950 mm
Interior width	1700 mm
Exterior width	1750 mm
Total width (incl. mudguard)	2400 mm
Interior length	2800 mm
Total length (incl. drawbar)	4500 mm
Gross vehicle weight	1800 kg
Power connection	230V, 16A
Capacity fresh water	400l
Capacity waste water	800l



**SOLAR SYSTEM**  
WITH 780 WP



**BATTERY PACK**  
200 AH+



**NARROW BODY WIDTH**  
NO EXTRA REAR-VIEW MIRRORS REQUIRED



**400 USES**  
WITHOUT SERVICE INTERVAL



**UP TO 72 HOURS**  
OF POWER WITHOUT RECHARGING



# GL4200 TOILET AND SHOWER TRAILERS



Subject to technical changes.  
Images may show optional equipment.

  
**MADE IN  
DÖBELN  
GERMANY**



- Various layouts of ladies and gents compartments
- Available with fresh water connection or as self-sufficient tank variants
- Custom interior configurations available

- High-quality and durable
- Non-slip floor surface
- Ceramic interior fittings
- Optionally available with vacuum technology or solar package

# LAYOUTS

**GL4200 212**

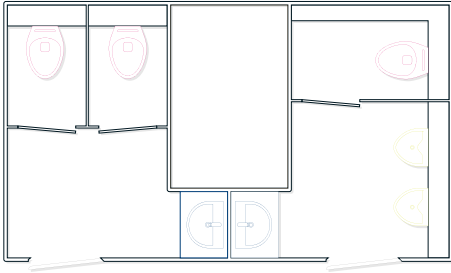

**GL4200 3x BATHROOM**

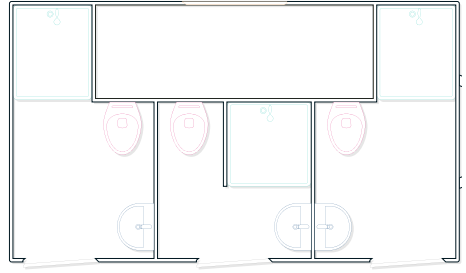

**GL4200 213**

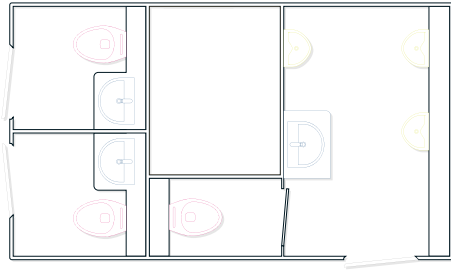

**GL4200 6SH-4WB**

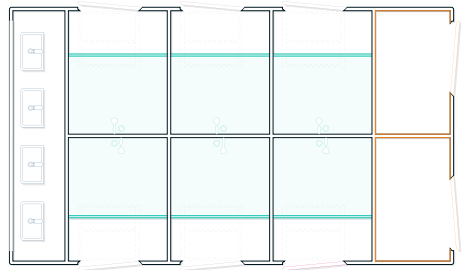

**GL4200 313**

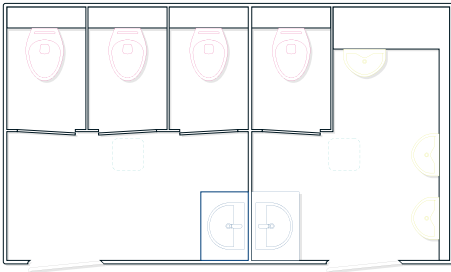

**GL4200 322**

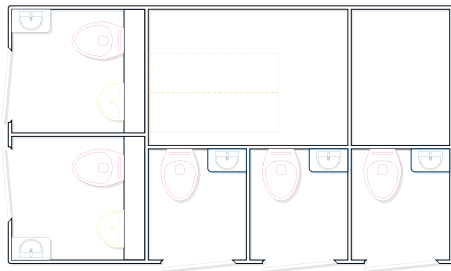

## SPECIFICATIONS

Number of axles*	1/2
Interior height	2150 mm
Total height	2950 mm
Interior width	2400 mm
Exterior width	2470 mm
Total width (incl. mudguard)	2400 mm
Interior length	4200 mm
Total length (incl. drawbar)	5800 mm
Gross vehicle weight*	1800/3500 kg
Power connection*	230 V/400 V, 16 A
Capacity fresh water*	800 l
Capacity waste water*	1500 l
Fresh water connection*	3/4"
Waste water connection*	DN110
Hot water supply with gas available on request	
*depending on model	

# GLOBAL EXPRESS 2

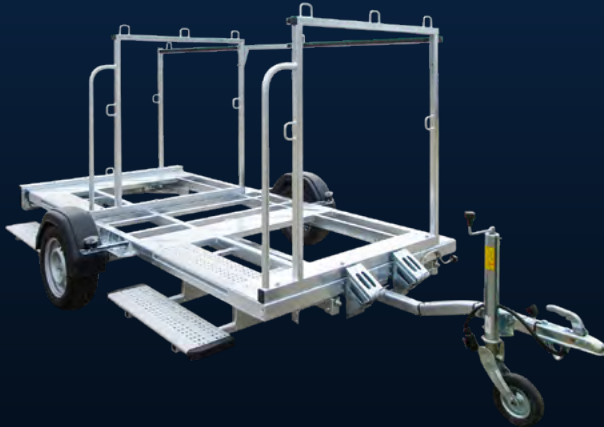

- Versatile transport trailer
- Single-axle chassis with tubular drawbar and ball coupling
- GVW 750 kg

- Hot-dip galvanized steel profile frame with aluminum panels
- Optimized for our portable toilets Focus, MTM and Polar

Subject to technical changes.  
Images may show optional equipment.



Find out more about the world of reliable sanitary systems at: [glo-bal.de](https://glo-bal.de)

GLOBAL Fahrzeugtechnik GmbH  
Zscheplitzer Str. 22  
04720 Döbeln  
Deutschland  
Email: [sales@glo-bal.de](mailto:sales@glo-bal.de)  
Tel.: +49 34903 64243